

### NOTE:

Actual product may vary. Superlever panels are interchangeable and instructions show a product representation.

### STEP ONE

- Align bases with handles facing the back of the Superwall Corner, and white feet on the bottom.
- Attach C3, C4's and C5R as shown.

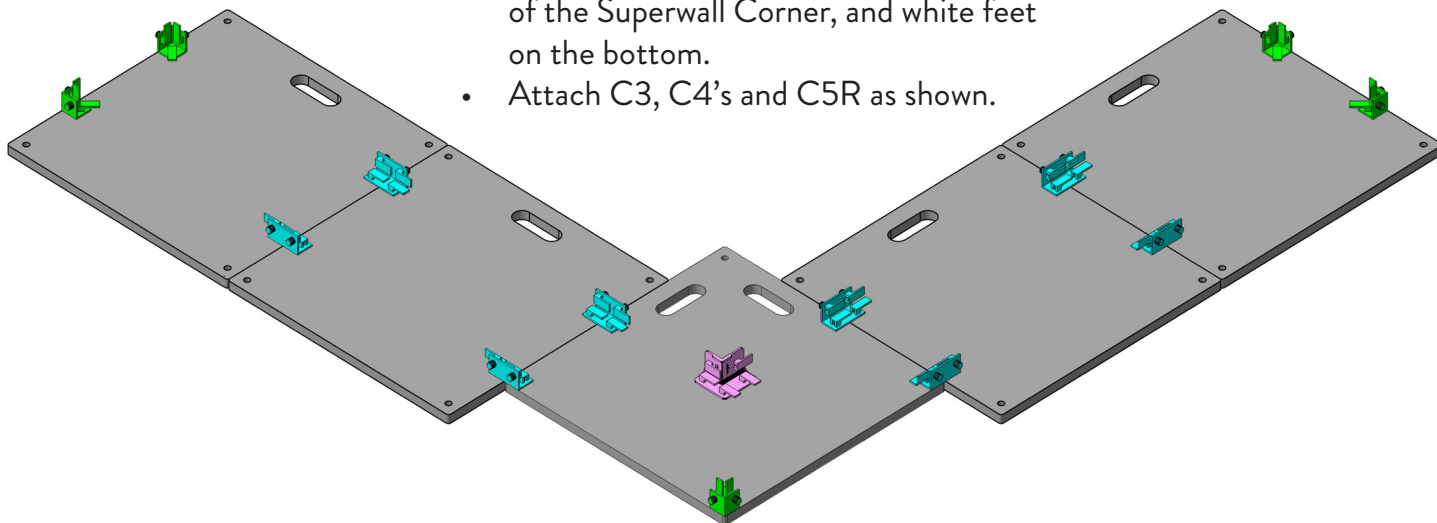

### STEP TWO

- Attach SuperLever Panels and Half Panels as shown.
- Attach C4 and Reverse Dogbone Connectors.

### NOTE:

To add lights inside Superwall use Mousehole panels to allow lighting cables to pass through.

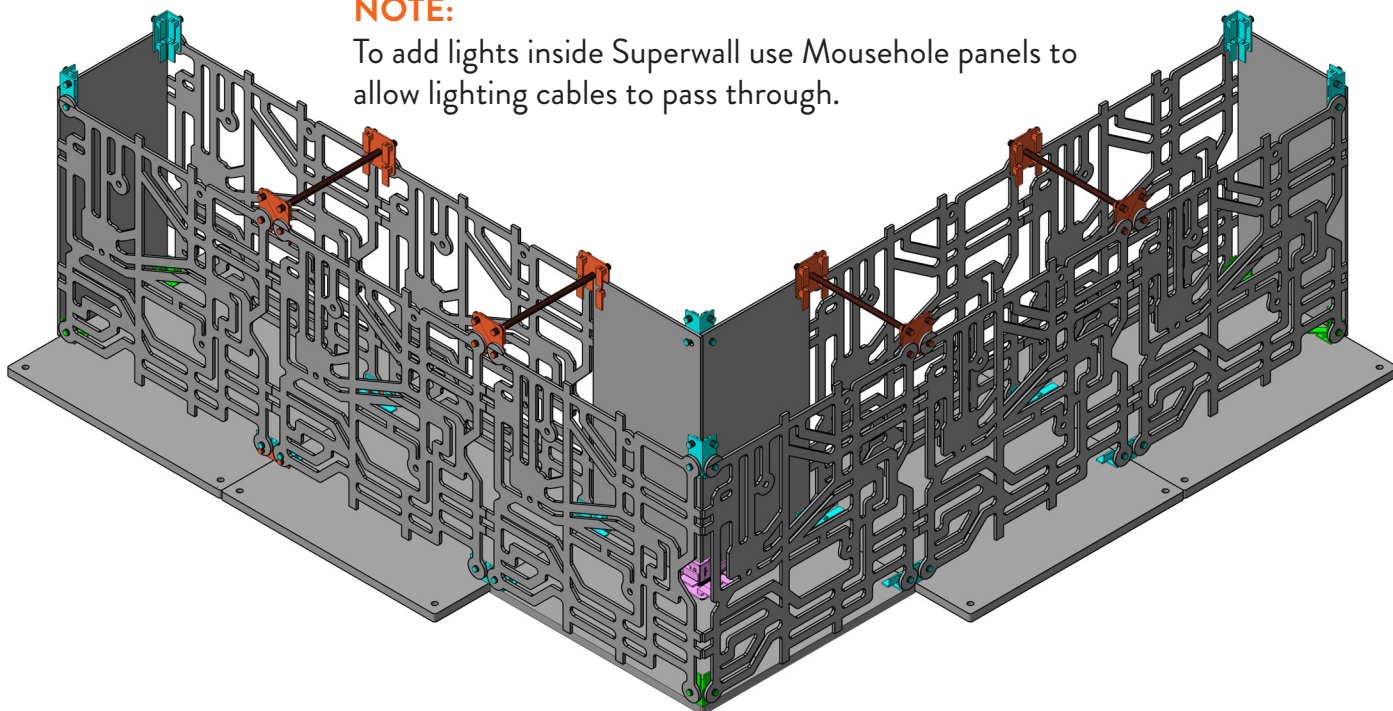

### STEP THREE

- Repeat STEP TWO for the middle rows of your SuperWall Corner unit.

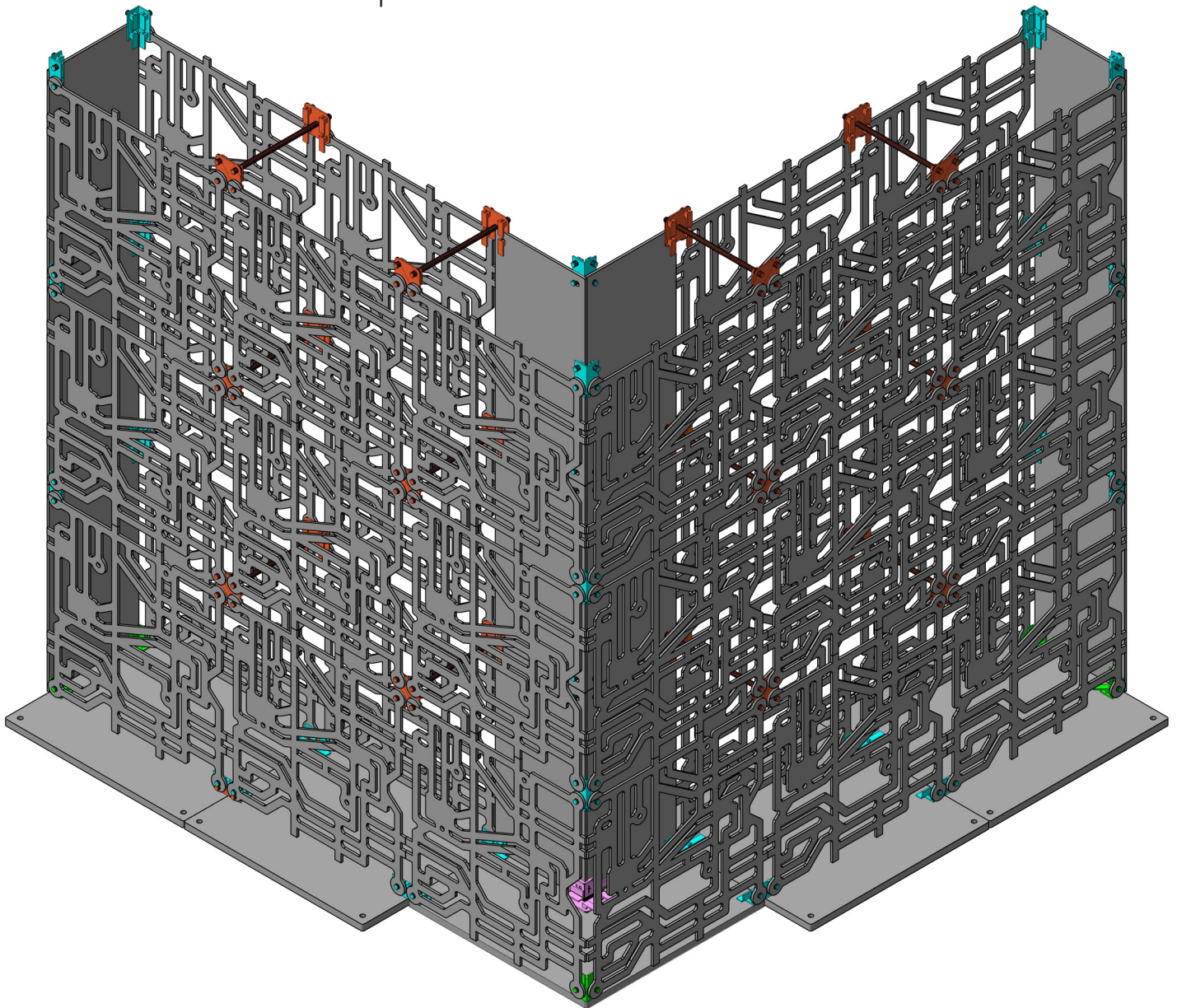

Questions about ATOMIC products?  
Contact your Modular Systems Account Manager!  
[www.atomicdesign.tv/contact](http://www.atomicdesign.tv/contact)



#### STEP FOUR

- For the top row of Superwall, attach SuperLever Panels and half panels.
- Attach C3's, C4's and C5L connectors as shown.

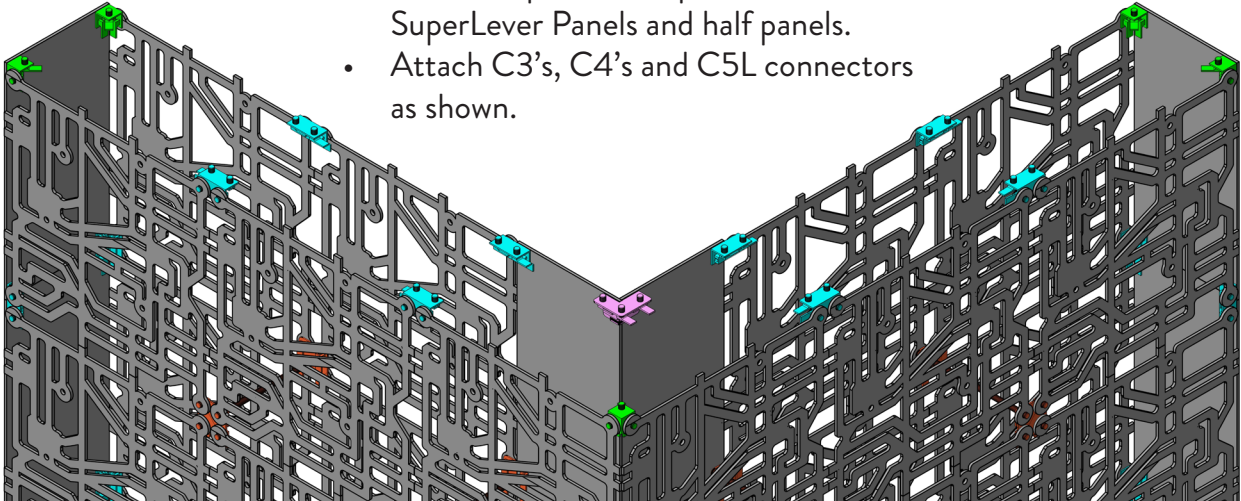

#### STEP FIVE

- Finish off the Superwall, attaching Half Panels and a Corner Panel as shown.

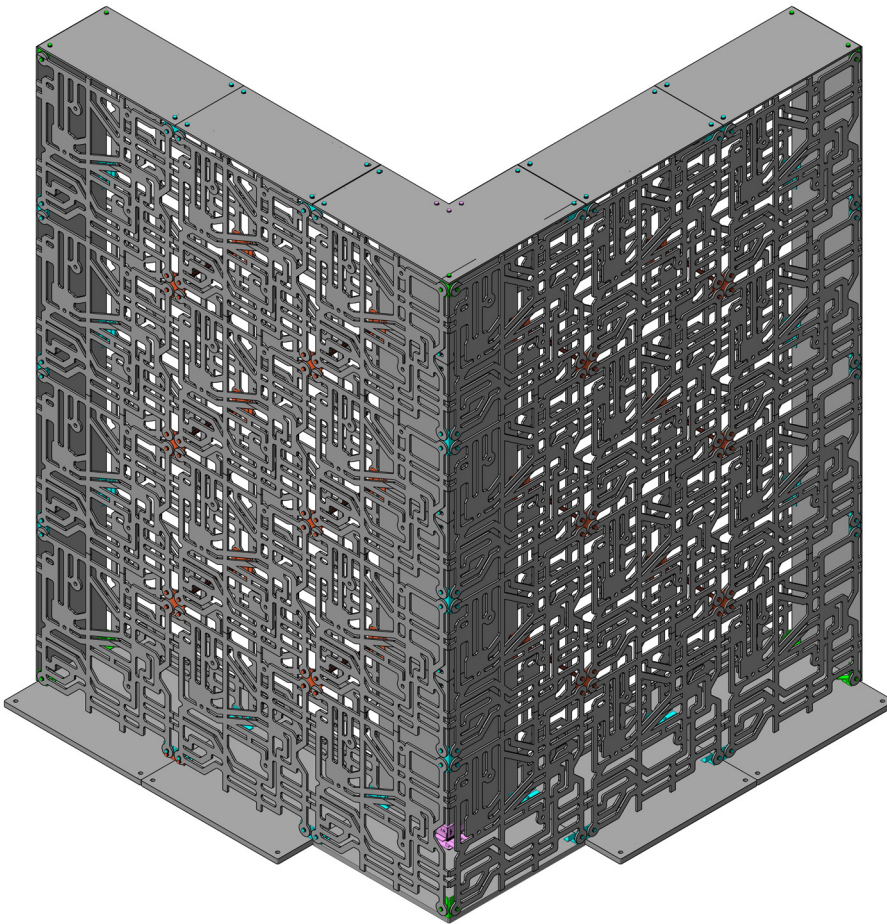

#### DISASSEMBLY INSTRUCTIONS:

Superwall MUST be disassembled from top down, in reverse order as the assembly process. Removal of bottom panels first may result in a collapsing wall.