

NOTE:

Actual product may vary. Superlever panels are interchangeable and instructions show a product representation. Reference the SuperLever connectors and Modular SuperWall sheets for instructions and images.

STEP ONE

Assemble bases of SuperArch according to Modular SuperWall installation instructions.

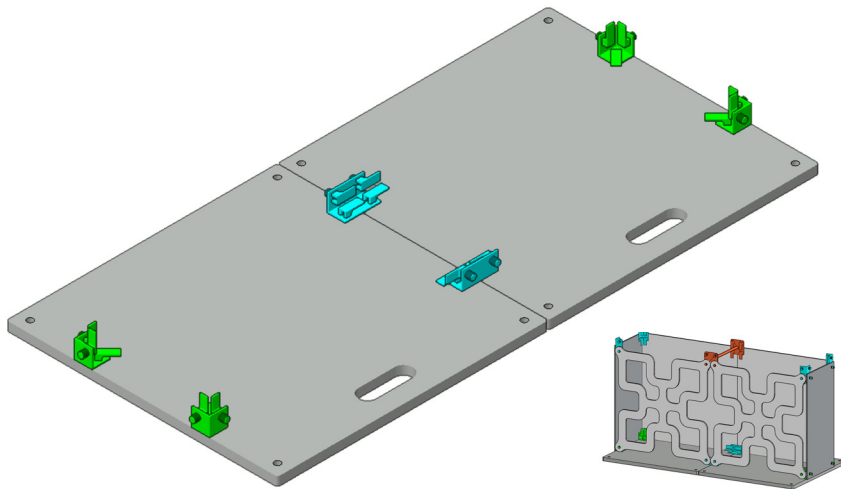

STEP TWO

Repeat base assembly so that it mirrors the first step, and move into position. These will be the vertical legs of the SuperArch.

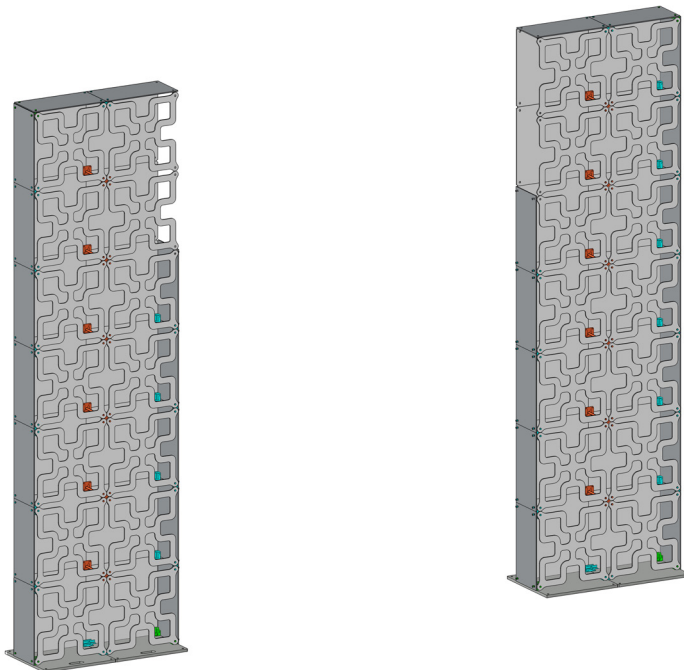
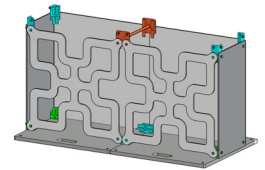

STEP THREE

Continue building the vertical legs as Modular SuperWall, leaving an opening in the side for the suspended middle section.

NOTE:

Opening in vertical legs will use C5 connectors.

Questions about ATOMIC products?
Contact your Modular Systems Account Manager!
www.atomicdesign.tv/contact

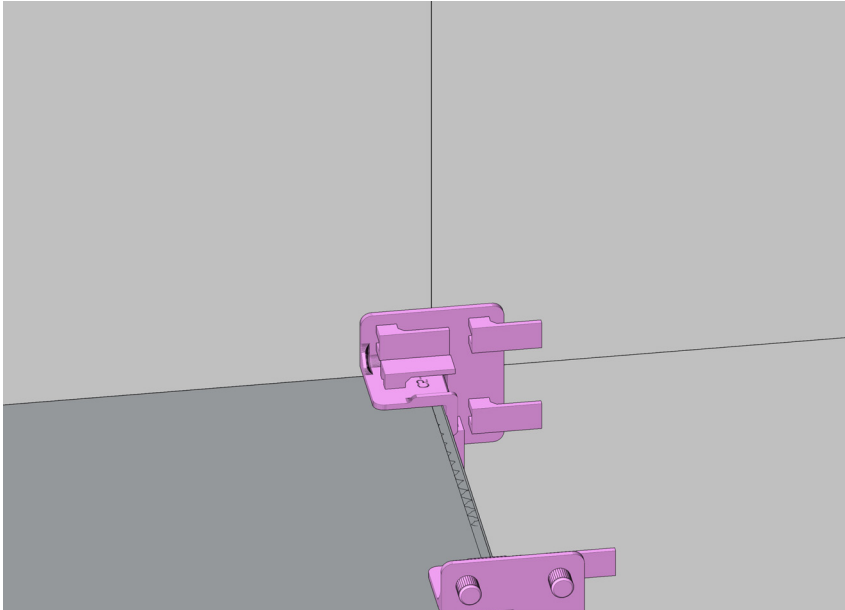

STEP FOUR

Attach C5 connector to vertical legs as illustrated

NOTE:

The C5 connectors are labeled LEFT and RIGHT to show where they attach.

STEP FIVE

Attach half panels to C5 connectors to continue building the suspended middle section of the arch.

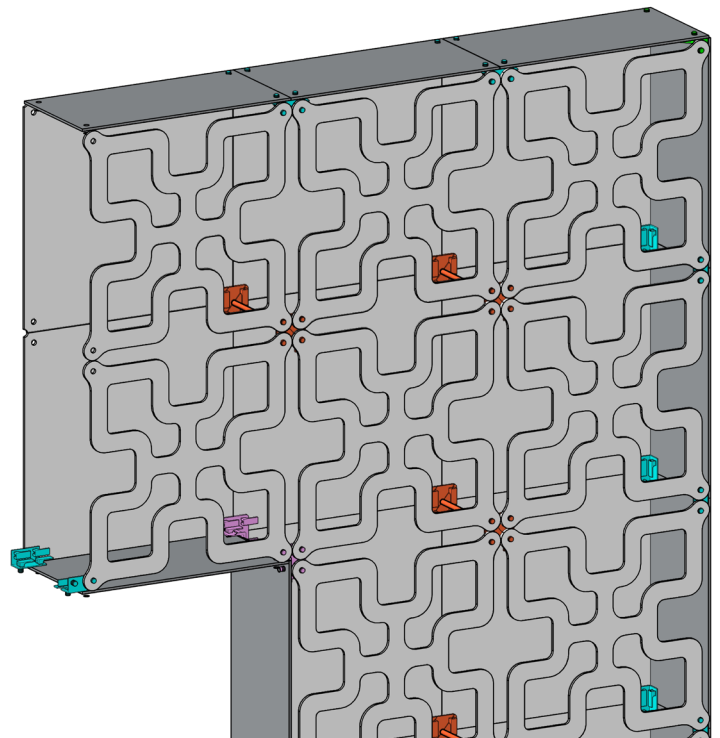

STEP SIX

Continue building suspended middle, one full section of panels at a time.

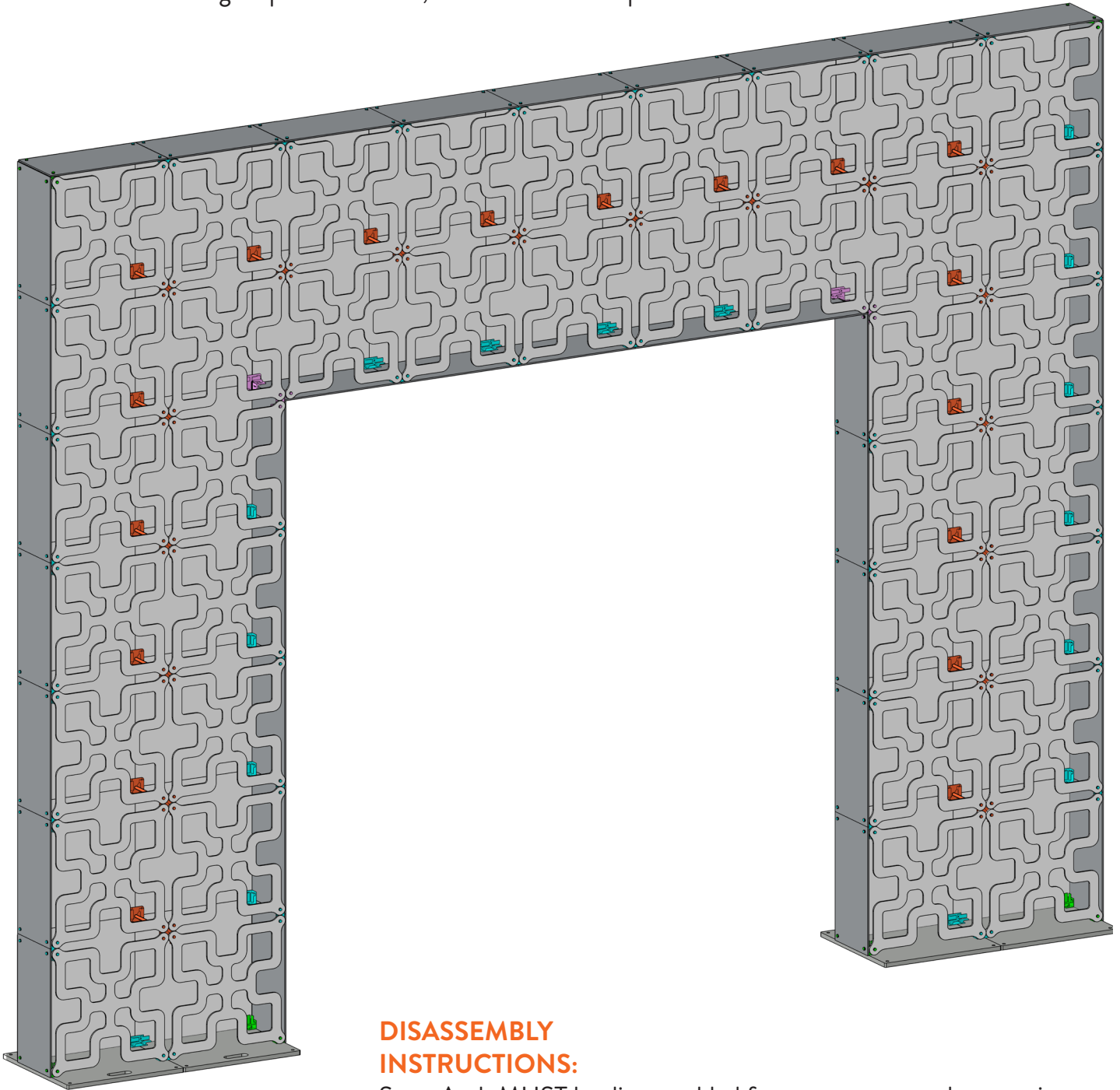

DISASSEMBLY INSTRUCTIONS:

SuperArch **MUST** be disassembled from center top to bottom, in reverse order as the assembly process. Removal of lower panels first may result in a collapse.

Questions about ATOMIC products?
Contact your Modular Systems Account Manager!
www.atomicdesign.tv/contact