

Standard
45" x 90"

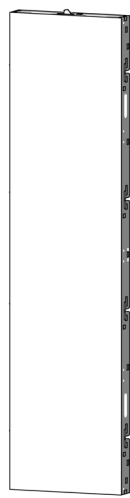

Tall
22.5" x 90"



Outside Full
Corner
4" x 90"



Inside Full
Corner
4.25" x 90"

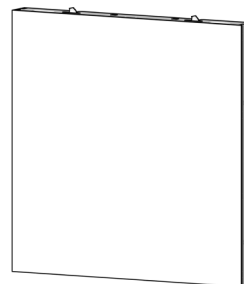

Squat
45" x 45"



Outside Half
Corner
4" x 45"



Inside Half
Corner
4.25" x 45"

NOTE:

SuperFlat requires two people to assemble. Never assemble alone.

STEP ONE

Stand one SuperFlat upright, with jack leg oriented down, and place in position.

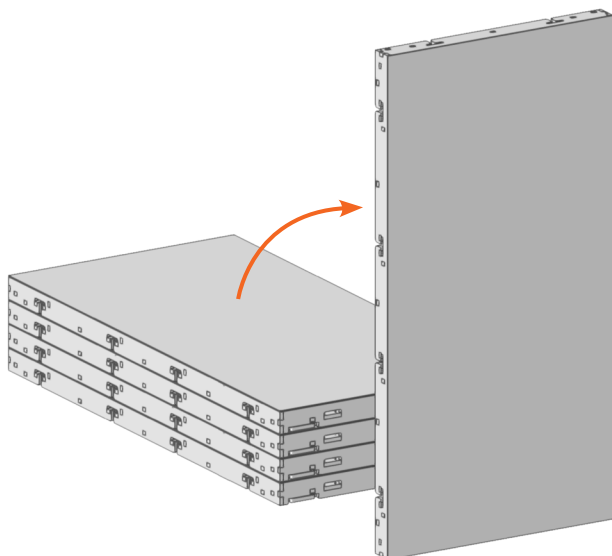

STEP TWO

Swing jack leg out and lock into position using hinged lock as shown.

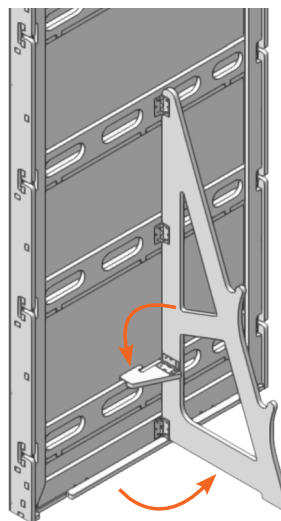

STEP THREE

Add sand bags for safety (50lb per SuperFlat).

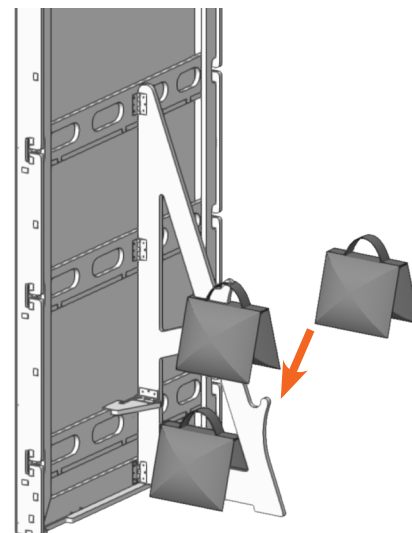

Questions about ATOMIC products?
Contact your Modular Systems Account Manager!
www.atomicdesign.tv/contact

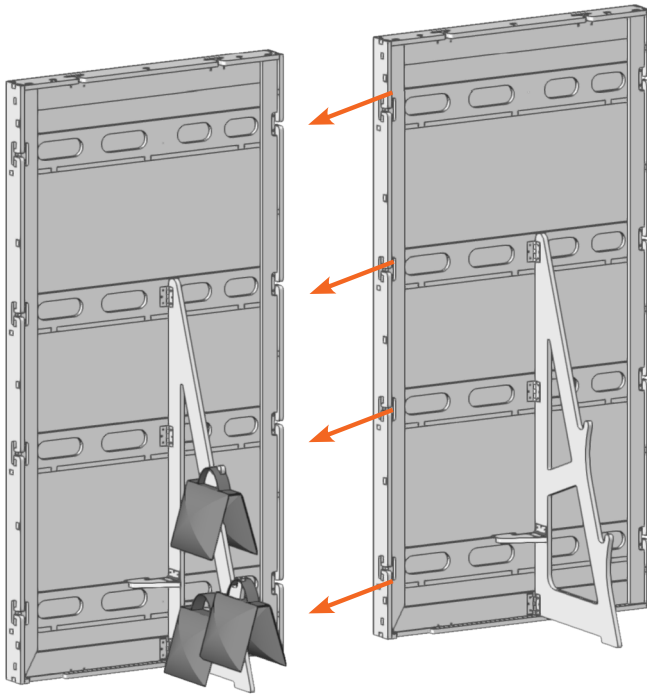

STEP FOUR

Place a second SuperFlat, repeating steps one and two.

STEP FIVE

Lock SuperFlats together by turning four coffin locks 180 degrees using supplied hex wrench.

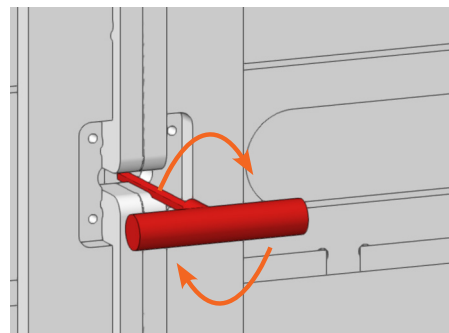
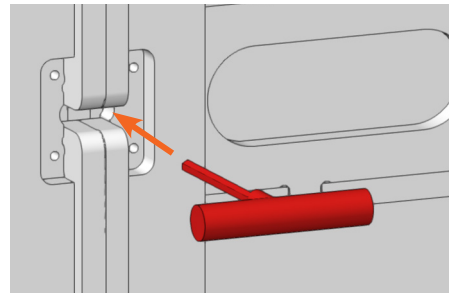
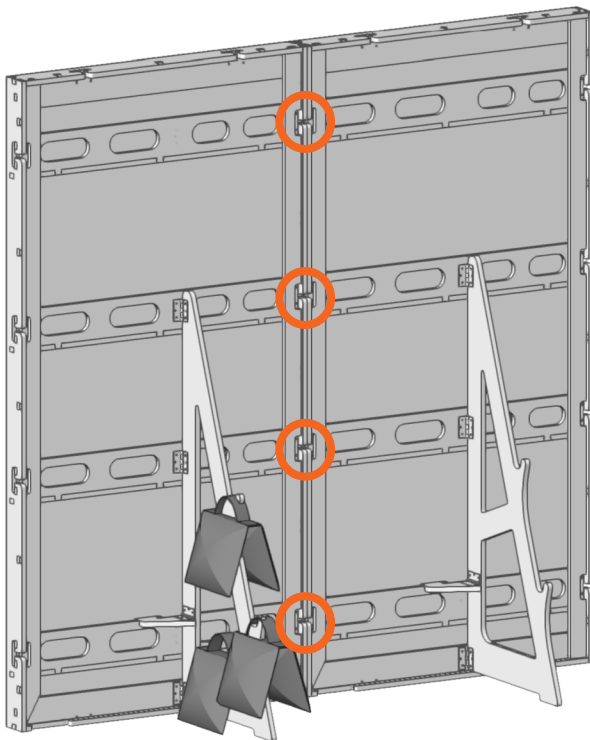

Questions about ATOMIC products?
Contact your Modular Systems Account Manager!
www.atomicdesign.tv/contact

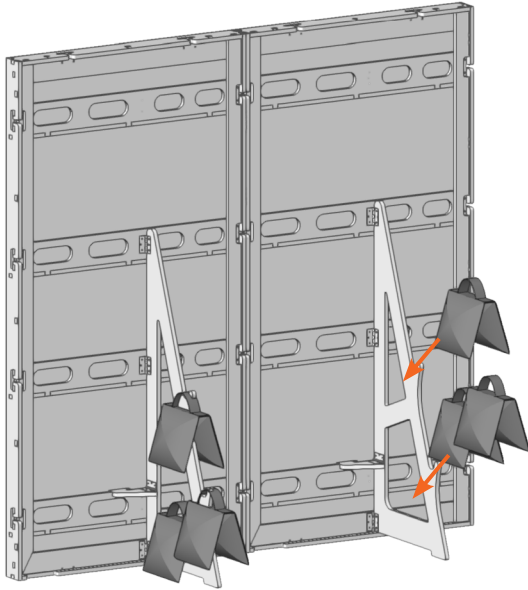

STEP SIX

Add sand bags to second SuperFlat.

NOTE:

If adding a SuperFlat on top, add an extra 50Lbs of sand bags to the jack stands.

STEP SEVEN

For additional height, mount SuperFlat horizontally on top of two vertical SuperFlats as shown. Secure using coffin locks as in step five.

NOTE:

Jack leg must remain closed on this flat to ensure safety.

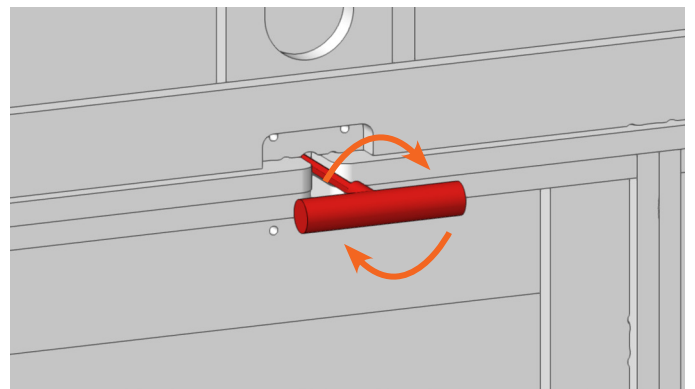
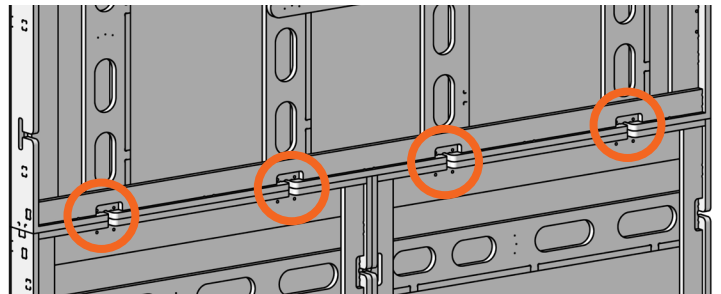
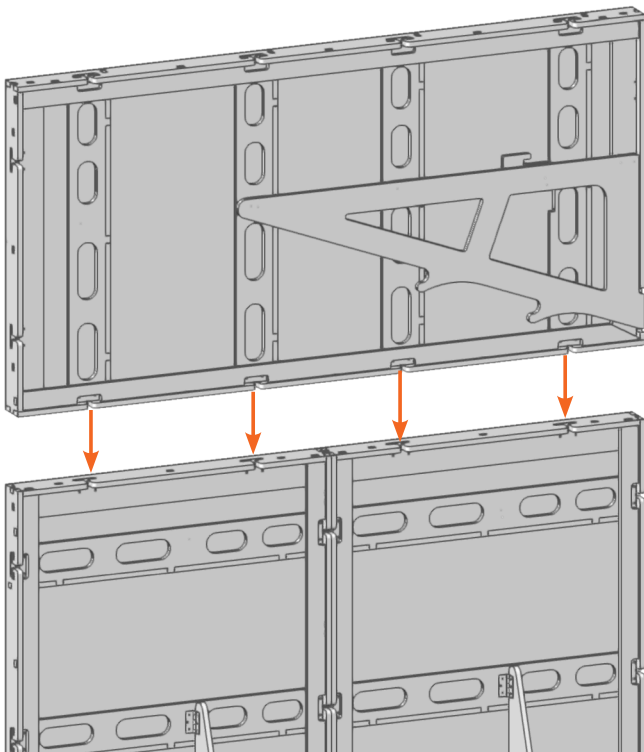

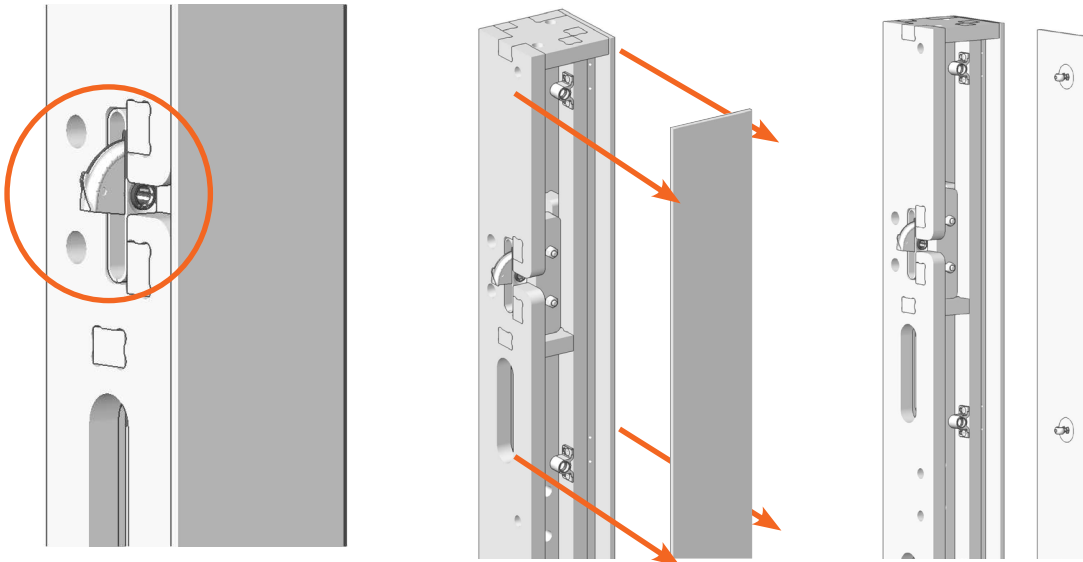

STEP EIGHT

On the Outside Corner units, in order to access the coffin locks on the corner pieces, you will need to remove each of the panels adjacent to the locks.

Use both hands to pull straight back on the panel. The first connection is 2" from the top and approximately 17" between each connection.

Follow step FIVE to connect the corners to the SuperFlats.

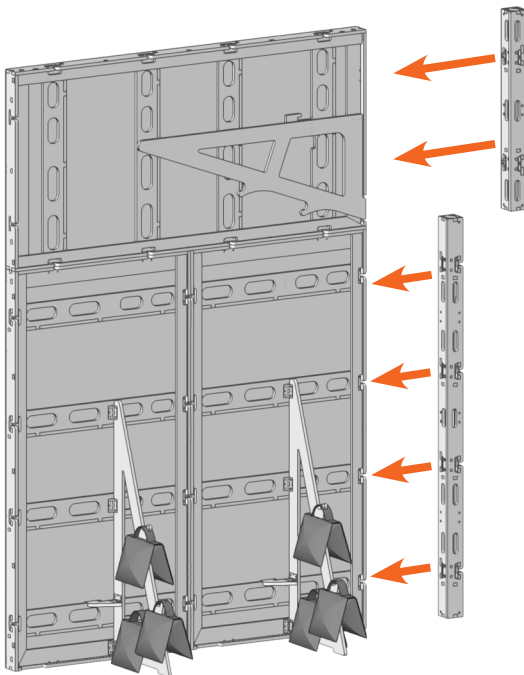

STEP NINE

Once panels are removed from the Outside Corner pieces, repeat step FIVE to lock corners onto SuperFlat set-up. Coffin Locks will be accessed in the front of the units.

NOTE:

Coffin Locks may be positioned upside down depending on the orientation of the Superflats they are connecting into.

STEP TEN

Follow steps ONE through SIX to set-up another SuperFlat. Attach this one to the corner perpendicular to the original SuperFlats set-up.

Attach a SuperFlat Squat on top of the SuperFlat just placed and lock this one into the Half Corner.

STEP ELEVEN

Once all SuperFlats are connected to the corner units, line up the face panel clips and press firmly around each connection to snap them back onto the corners.

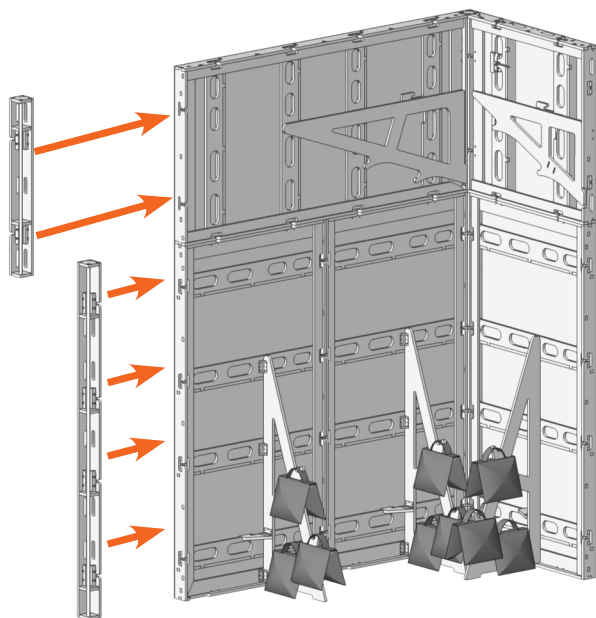
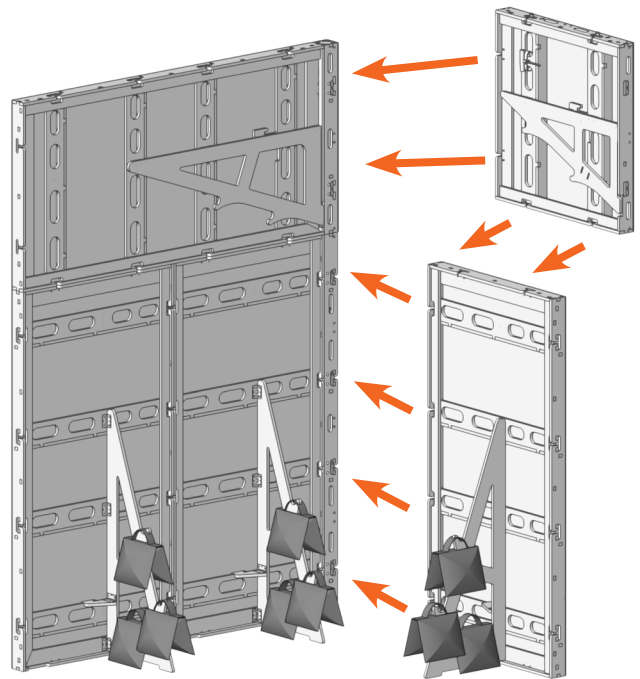

STEP TWELVE

Repeat step FIVE to connect Inside Corners. Access the Coffin Locks from the back side of the corners. Ensure you are lining up Male to Female coffin locks.

NOTE:

Coffin Locks may be positioned upside down depending on the orientation of the Superflats they are connecting into.

STEP THIRTEEN

Repeat step TEN to connect SuperFlats to the Inside Corners. Lock the SuperFlats in place from the backside of the corners. Add sand bags as per previous steps.

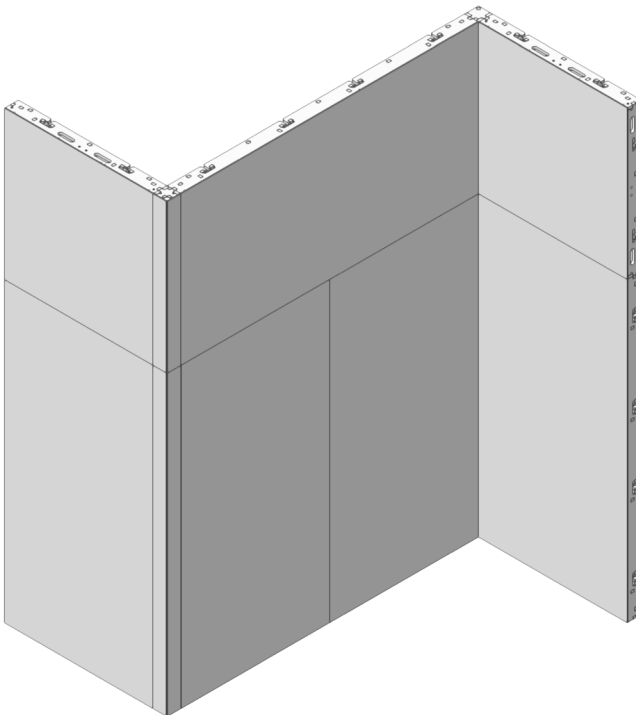
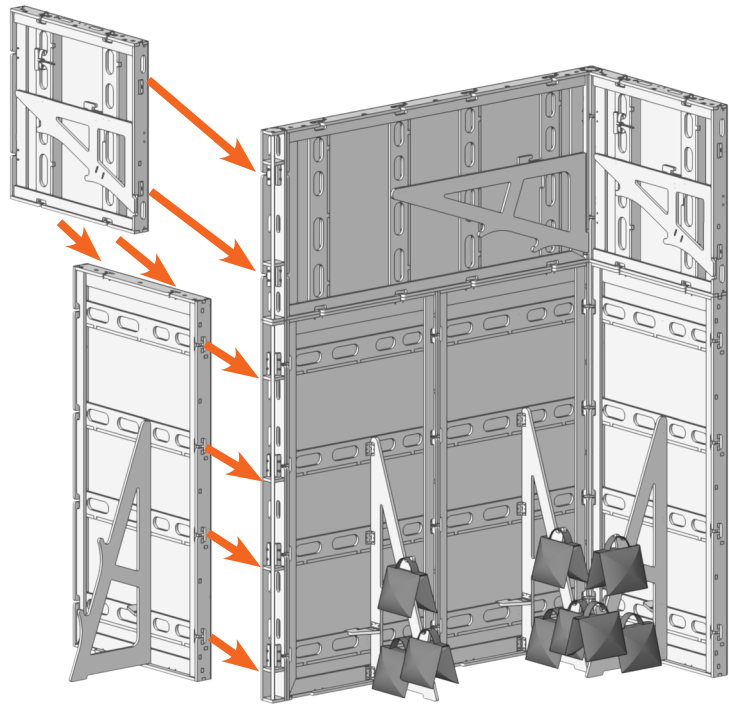

DISASSEMBLY INSTRUCTIONS:

Disassemble SuperFlats in reverse order as instructed. Remove top SuperFlats first, leaving sandbags in place.