

### NOTE

- Zig Zags should be limited to (3) units to a 20Amp circuit.

### STEP ONE

- Position Zig Zag box under truss.

### NOTE

- Orientation is shown on the box.

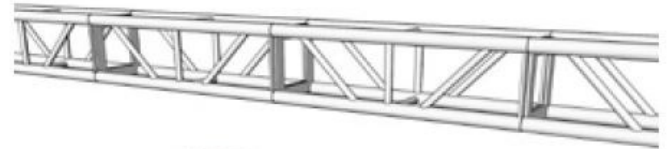

### STEP TWO

- Remove lid and set aside. Install Zig Zag rigging as shown.

### NOTE

- All rigging is to be performed by ATOMIC on-site supervisors or licensed rigging professionals.
- If lighting power/control is positioned from above, connect cables before raising truss.

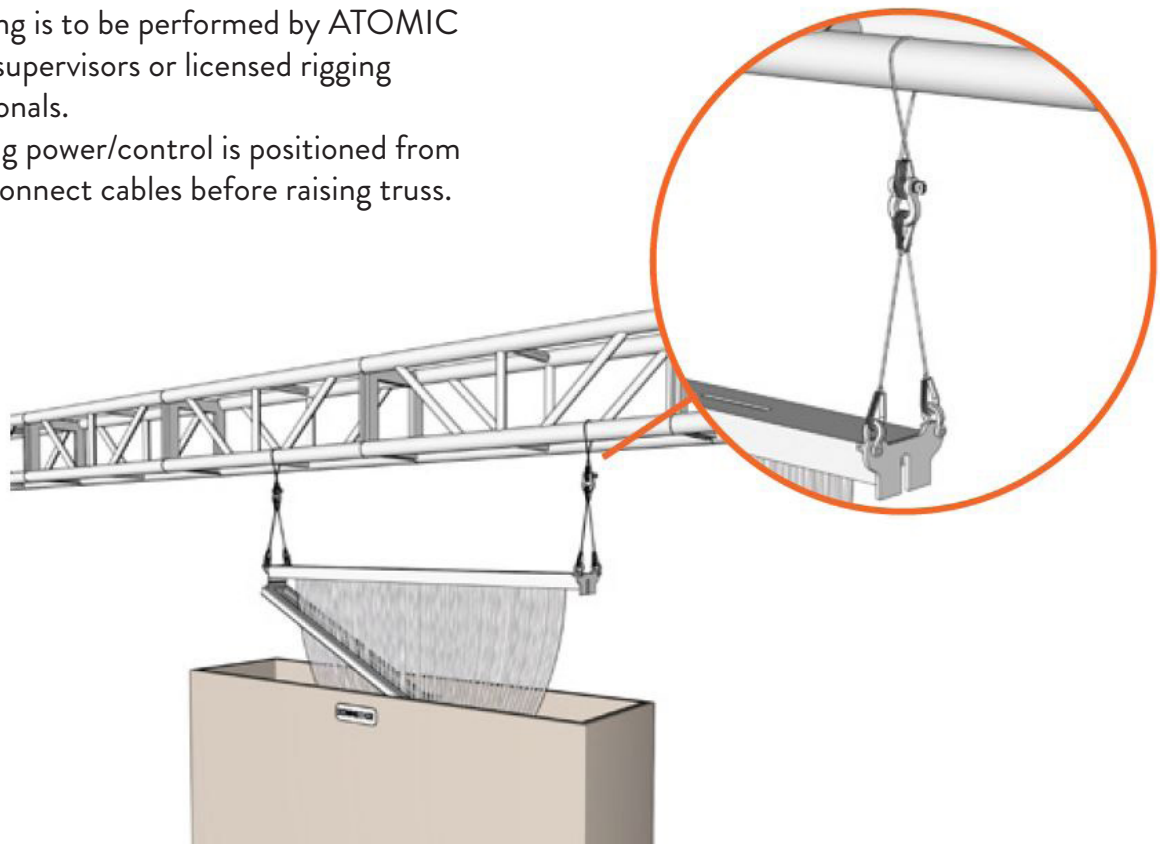

Questions about ATOMIC products?  
Contact your Modular Systems Account Manager!  
[www.atomicdesign.tv/contact](http://www.atomicdesign.tv/contact)

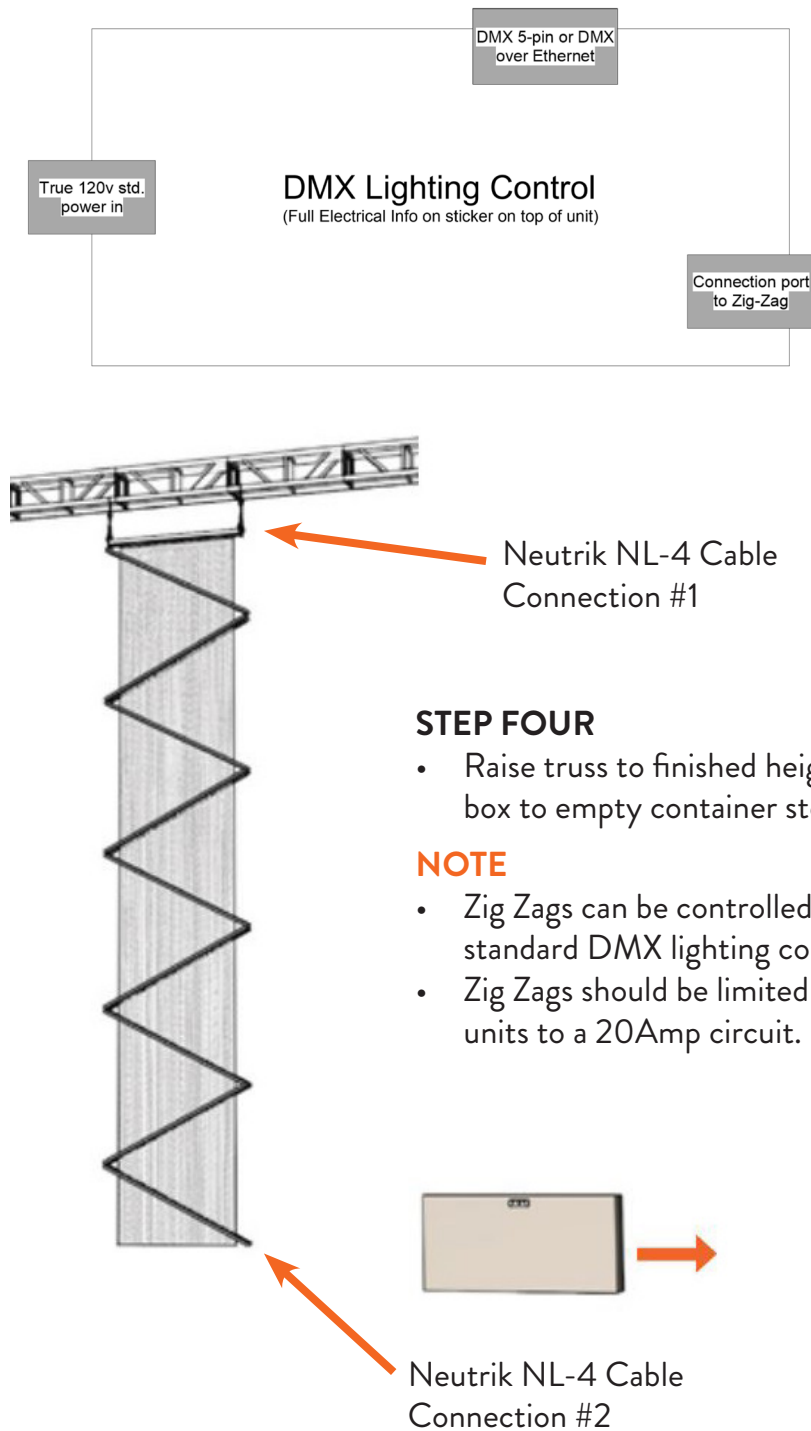

### STEP THREE

- Raise truss, untying string curtain and keeping cables free from tangles as truss is raised.

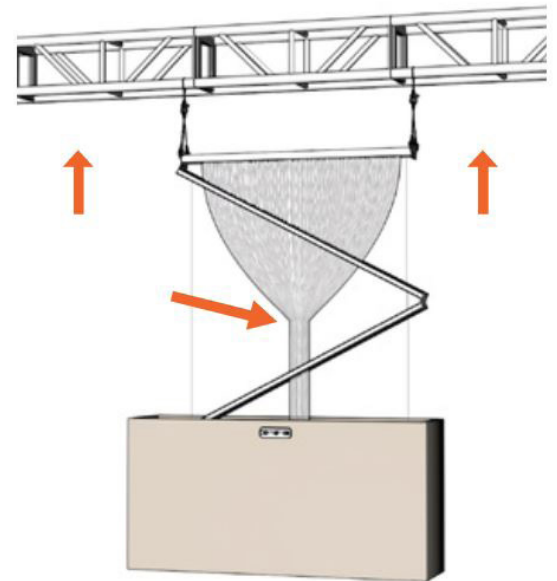

### DISASSEMBLY INSTRUCTIONS

When packing Zig Zag, ensure cables are free from tangles and string curtains are gathered and tied at each joint to prevent damage.

Questions about ATOMIC products?  
Contact your Modular Systems Account Manager!  
[www.atomicdesign.tv/contact](http://www.atomicdesign.tv/contact)