

STEP ONE

Position Zig Zag box under truss.
Note orientation shown on box
labels.

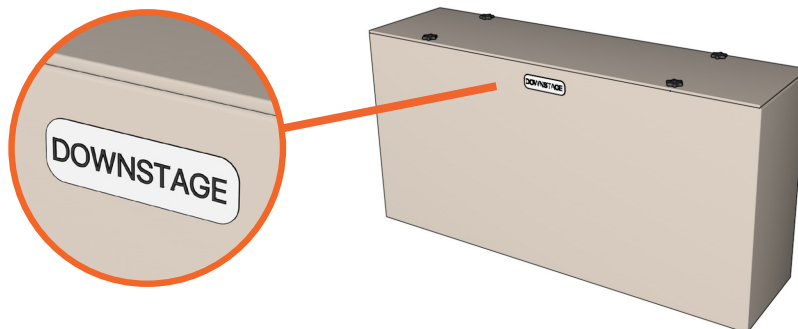
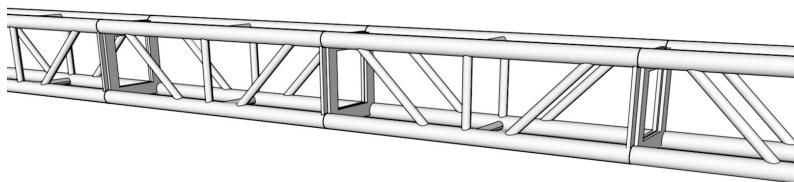

STEP TWO

Remove lid and set aside. Install Zig Zag rigging as shown

NOTE:

All rigging is to be performed by ATOMIC on-site supervisors or licensed rigging professionals.
If lighting power/control is positioned from above, connect cables before raising truss.

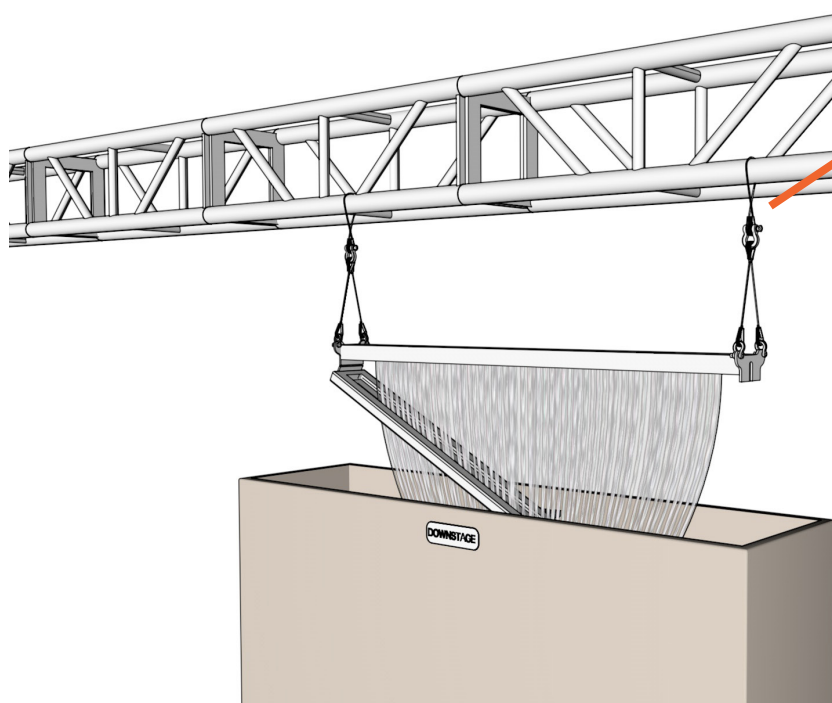
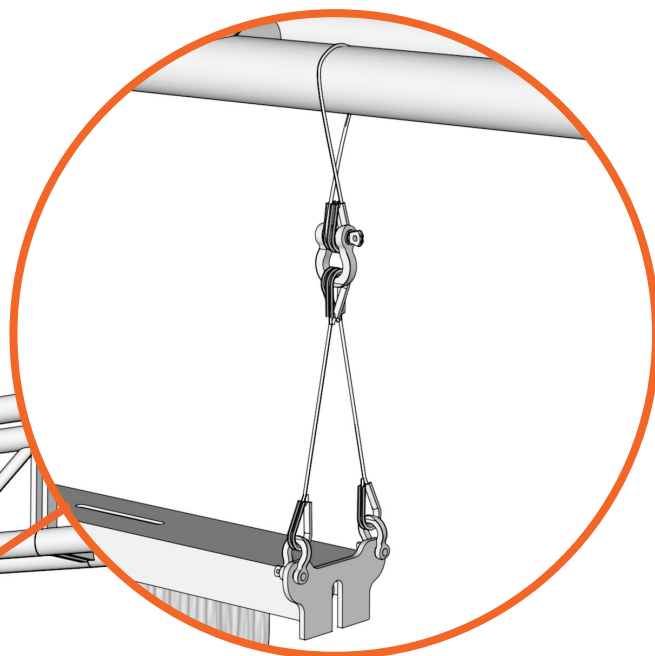

STEP THREE

Raise truss, untying string curtain and keeping cables free from tangles as truss is raised

STEP FOUR

Raise truss to finished height. Move box to empty container storage.

NOTE:

Zig Zags can be controlled with standard DMX lighting control.

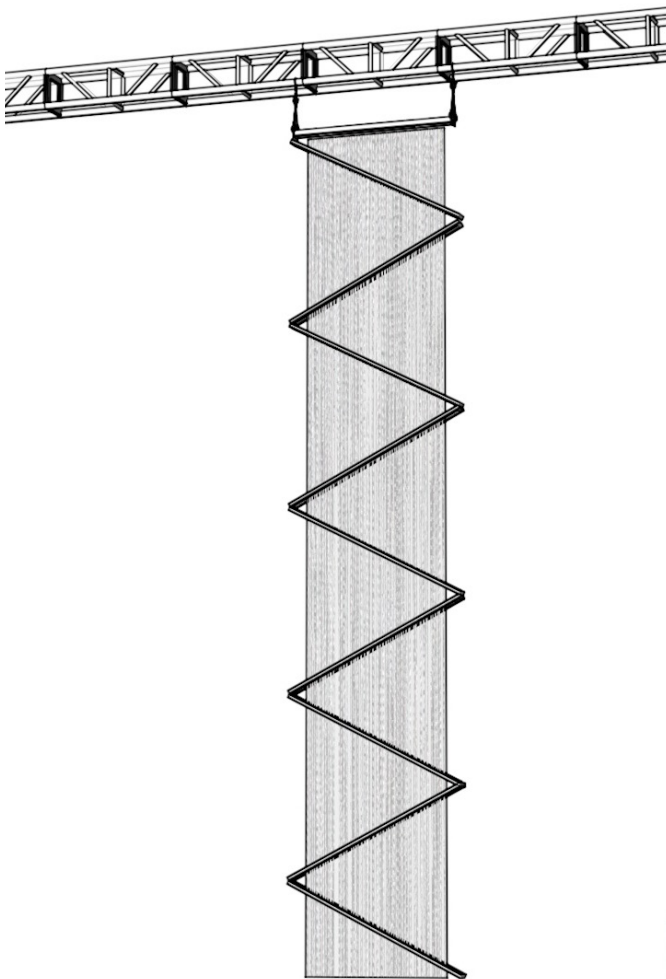
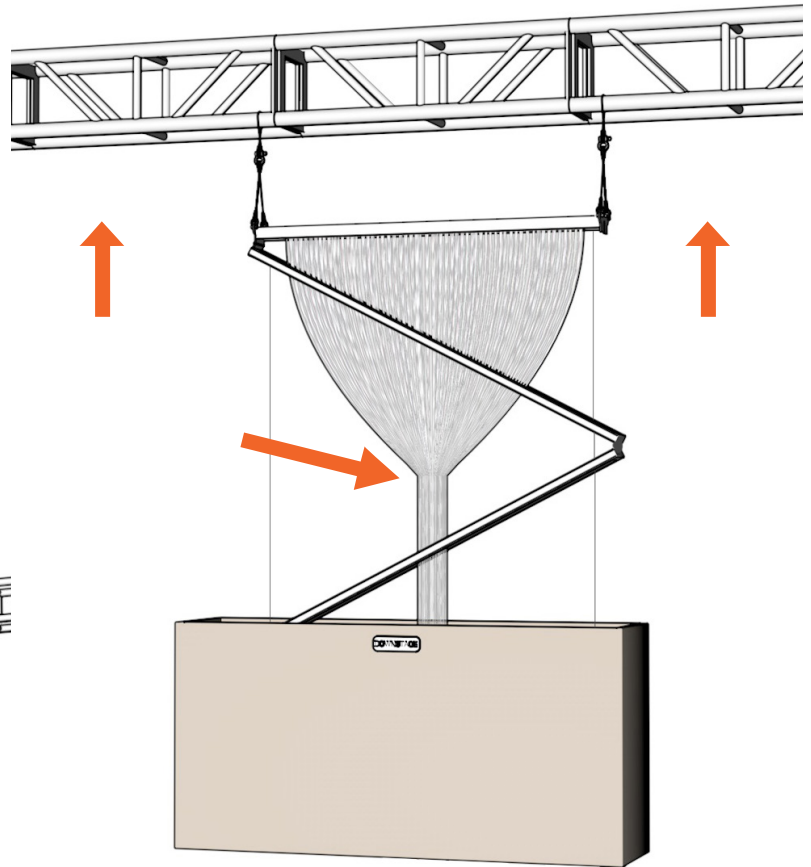

DISASSEMBLY INSTRUCTIONS

When packing Zig Zag, ensure cables are free from tangles and string curtains are gathered and tied at each joint to prevent damage.

