

STEP ONE

Attach C3 connectors to each corner of the Superbase.

STEP TWO

Attach a half Bubblegum panel to each side of the base and secure it with the C3 connectors.

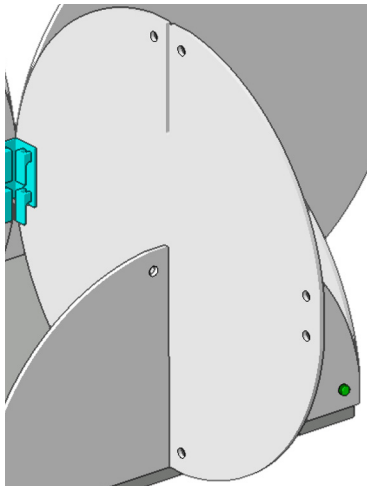
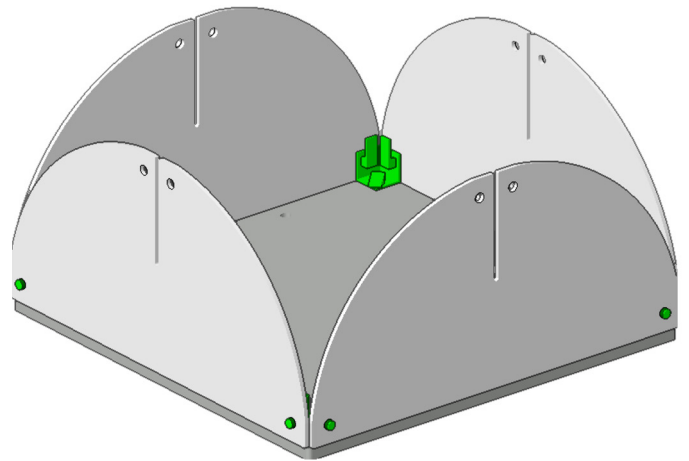

STEP THREE

Attach whole Bubblegum panels into the slot of half Bubblegum panels as shown. Connect whole Bubblegum panels in center using C4 connector.

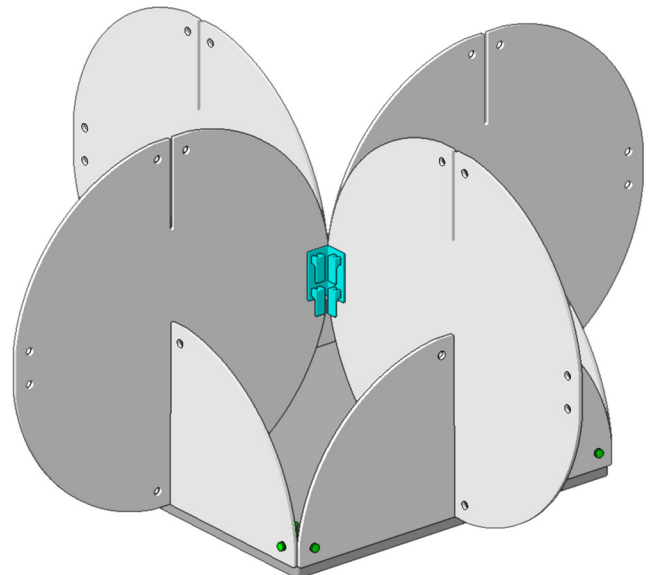

Questions about ATOMIC products?
Contact your Modular Systems Account Manager!
www.atomicdesign.tv/contact

STEP FOUR

Continue to build using whole Bubblegum panels. Connect each Bubblegum panel at outside corners using C4 connectors.

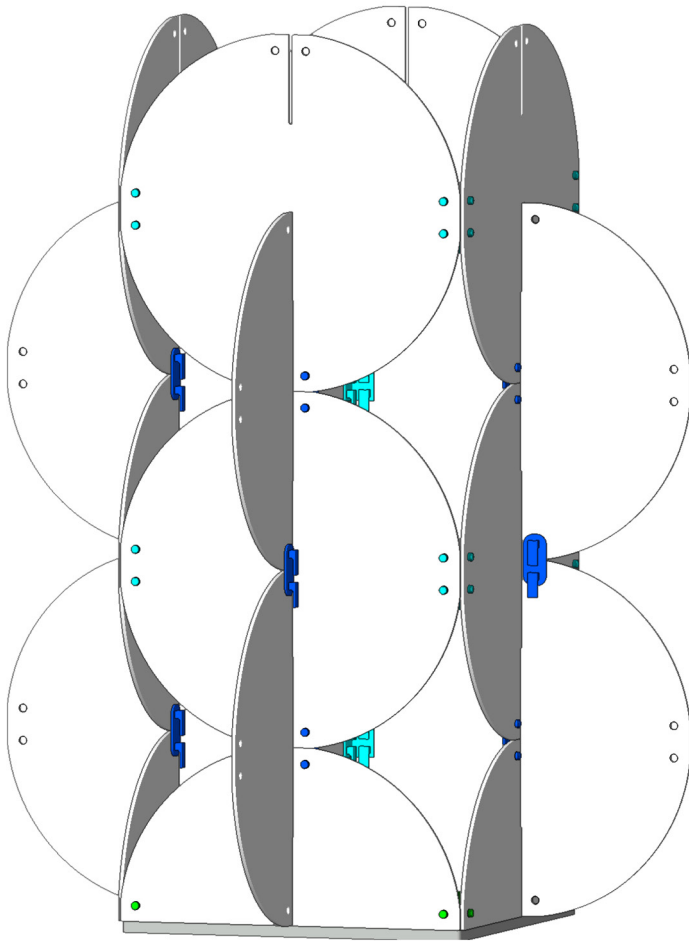
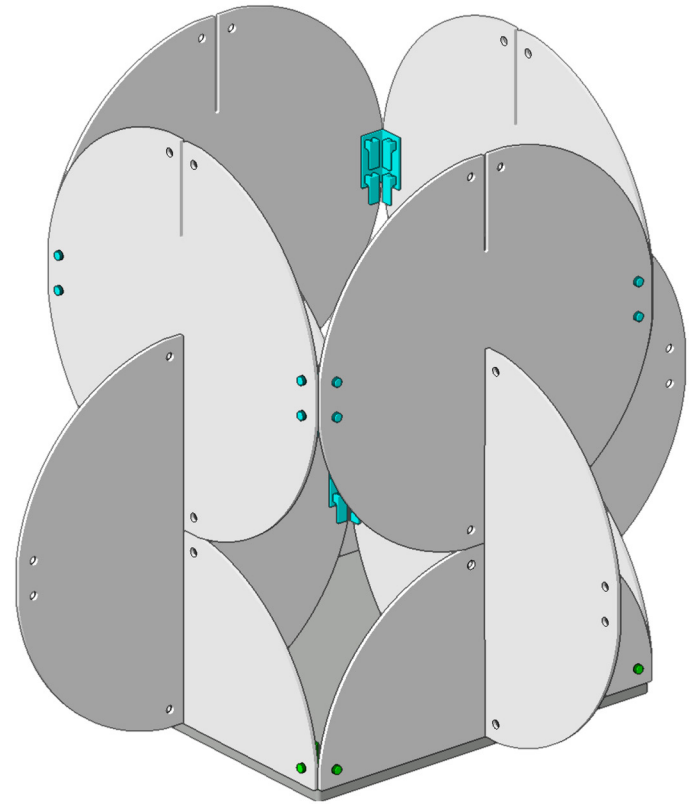

STEP FIVE

Use an F2 connector to secure the next layer of Bubblegum panels on the inside column at each connection as shown.

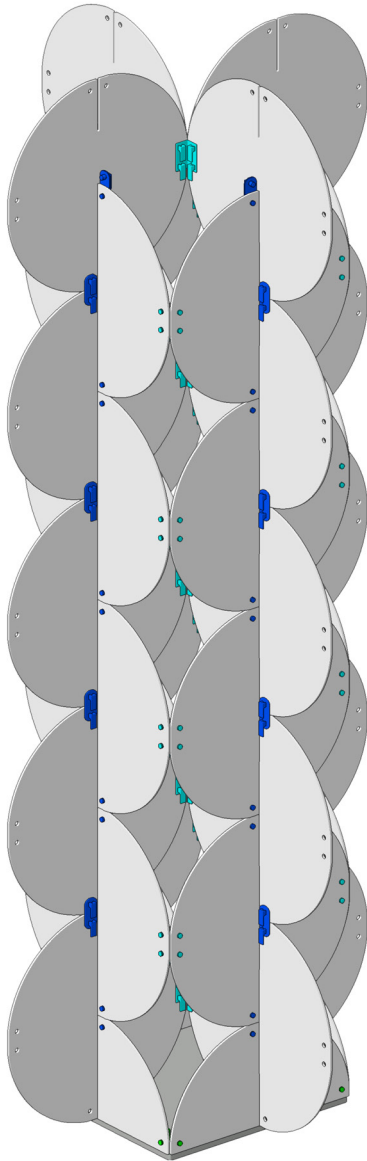

NOTE:

Bubblegum columns can be built to a maximum of 6 panels high.

STEP SIX

Finish Bubblegum column by attaching half Bubblegum panels. Connect outside corners using C2 connectors as shown.

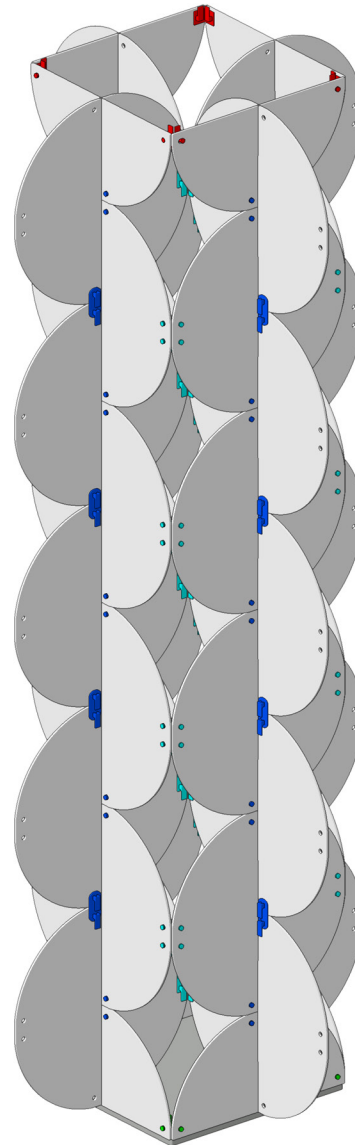

Questions about ATOMIC products?
Contact your Modular Systems Account Manager!
www.atomicdesign.tv/contact